

REVISION	DATE	LAPP INSULATORS LLC LEROY, N.Y. 14482	No. SDJ-053161PA & PA-70	TITLE	STATION POST ASSEMBLY
REDRAWN ON CAD	3-28-07 DJB				
CORRECTED ELECTRICAL VALUES	04-21-09 JRC	UNITS in. (mm)	ORG.DATE 3-28-07	DWN. <i>J. Burgess</i>	APP.
REF.					

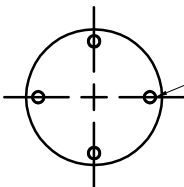
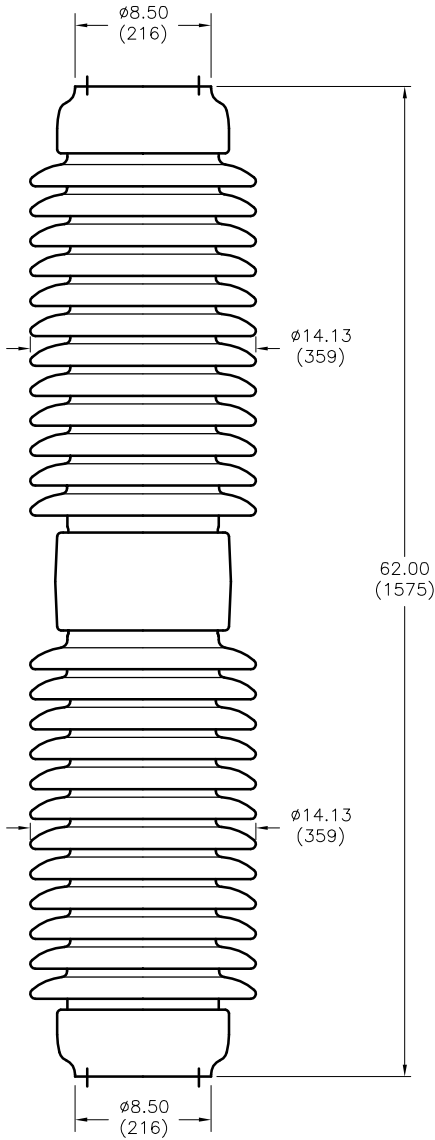
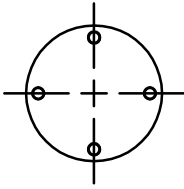

4 TAPPED HOLES
 3/4-10 +.015 OVERSIZE
 .88 (22) MIN. FULL THREAD
 ON 7.00 (178) B.C.
 BOTH ENDS

DIMENSIONS

LEAKAGE DISTANCE, in. (mm) 144 (3658)

MECHANICAL VALUES

CANTILEVER STRENGTH, lb. (kN) 3500 (15.6)

TENSION STRENGTH, lb. (kN) 40000 (177.9)

TORSION STRENGTH, in-lb. (kNm) 120000 (13.5)

COMPRESSION STRENGTH, lb. (kN) 120000 (533.8)

ELECTRICAL VALUES

CRITICAL IMPULSE FLASHOVER, POS., kV. 810

LOW FREQUENCY WET WITHSTAND, kV. 315

IMPULSE WITHSTAND, kV. 750

RADIO INFLUENCE VOLTAGE

TEST VOLTAGE, RMS TO GROUND, kV. 103

MAXIMUM RIV - MICROVOLTS AT 1000 kHz 200

NOTES:

1. DIMENSIONS ARE IN INCHES (MILLIMETERS)
2. ALL FERROUS PARTS ARE HOT DIP GALV. PER ASTM A153

ASSEMBLY	GLAZE COLOR
J-053161PA	CHOCOLATE
J-053161PA-70	LIGHT GRAY No.70

NOTE TO PURCHASER
 ALL SALES OF LAPP PRODUCTS ARE
 SUBJECT TO OUR STANDARD TERMS
 AND CONDITIONS AND THE LIMITED
 WARRANTIES THEREUNDER.