

REVISION HISTORY	DATE
DRAWING / DESIGN CREATED	01-30-95 JRC
REDESIGNED, TORSION RATING WAS 60,000	01-27-03 JRC

**LAPP**  
**INSULATOR COMPANY**  
 LEROY, N.Y. 14482  
 (585) 768-6221  
**SUBSTATION DIVISION**

BASE PART NUMBER  
**315019 (SERIES)**  
 (SEE TABLE FOR VERSIONS)  
 TITLE  
**STATION POST ASSEMBLY**  
 REF. TECHNICAL REFERENCE No. TR-19

**DIMENSIONS**

LEAKAGE DISTANCE, in. (mm) **99 (2515)**

**MECHANICAL VALUES**

CANTILEVER STRENGTH, lb. (kN) **1700 (7.6)**

TENSION STRENGTH, lb. (kN) **20000 (89.0)**

TORSION STRENGTH, in-lb. (kNm) **40000 (4.52)**

COMPRESSION STRENGTH, lb. (kN) **60000 (266.9)**

**ELECTRICAL VALUES**

CRITICAL IMPULSE FLASHOVER, POS., kv. **610**

LOW FREQUENCY WET WITHSTAND, kv. **230**

IMPULSE WITHSTAND, kv. **550**

**RADIO INFLUENCE VOLTAGE**

TEST VOLTAGE, RMS TO GROUND, kv. **73**

MAXIMUM RIV - MICROVOLTS AT 1000 kHz **200**

**NOTES:**

1. DIMENSIONS ARE IN INCHES [MILLIMETERS]
2. ALL FERROUS PARTS ARE HOT DIP GALV. PER ASTM A153

ASSEMBLY	GLAZE COLOR
J-315019	CHOCOLATE
J-315019-70	LIGHT GRAY No.70

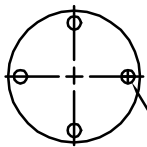
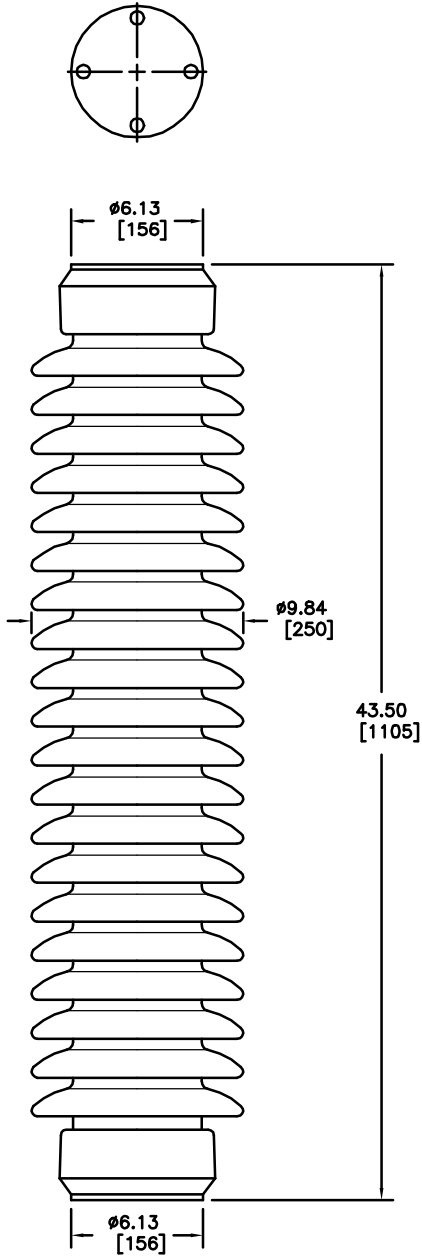

4 TAPPED HOLES  
 5/8-11 +.015 OVERSIZE  
 .69 [17] FULL THREAD  
 ON 5.00 [127] B.C.  
 BOTH ENDS

NOTE TO PURCHASER  
 ALL SALES OF LAPP PRODUCTS ARE  
 SUBJECT TO OUR STANDARD TERMS  
 AND CONDITIONS AND THE LIMITED  
 WARRANTIES THEREUNDER.