

# LAPP INSULATOR

LeRoy, N.Y. 14482

No. SDF-4688 & A & -70

TITLE

HORIZONTAL LINE POST

DATE 3-19-56

REV. 2-13-92

DWN. *J. Corona*

CHK.

APP.

SCALE 1/8

REF.

BK.No. 82E1

DIMENSIONS ARE IN INCHES (MILLIMETERS)  
ALL FERROUS PARTS ARE HOT DIP GALVANIZED

NOTE TO PURCHASER  
ALL SALES OF LAPP PRODUCTS ARE  
SUBJECT TO OUR STANDARD TERMS  
AND CONDITIONS AND THE LIMITED  
WARRANTIES THEREUNDER.

ASSEMBLY NO.	GLAZE COLOR
F-4688	CHOCOLATE
F-4688-70	LIGHT GRAY No.70
F-4688-A	GRAY

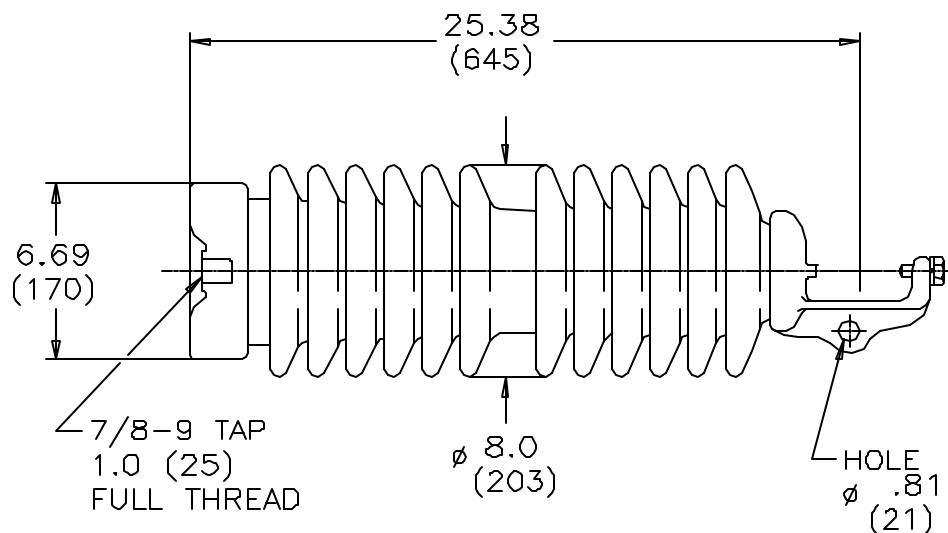

## ELECTRICAL PATH DISTANCES

LEAKAGE DISTANCE, INCHES (mm)	53 (1346)
DRY ARCING DISTANCE, INCHES (mm)	19.25 (489)

## MAXIMUM MECHANICAL DESIGN VALUES

CANTILEVER LOAD, LBS. (kN)	2800 (12.45)
TENSION LOAD, LBS. (kN)	5000 (22.24)

## ELECTRICAL VALUES

USUAL LINE VOLTAGE, kV.	88
LOW FREQUENCY DRY FLASHOVER, kV	200
LOW FREQUENCY WET FLASHOVER, kV	180
CRITICAL IMPULSE FLASHOVER, POS., kV	330
CRITICAL IMPULSE FLASHOVER, NEG., kV	425

## RADIO INFLUENCE VOLTAGE

TEST VOLTAGE, RMS TO GROUND, kV	44
MAXIMUM RIV AT 1000 KHZ, MICROVOLTS	200